



QUICK COUPLER

Series WQ

Cat No WQ - 01 - 01

QUICK COUPLER - 5NW, 8NW

Features

- Nickel plated brass body
- High flow characteristics
- Wide range of models
- Maintenance free and long life
- Compact size
- Attractive design
- Teflon pre-coated male taper threads



Applications

This can be effectively used in all compressed air line applications
Some of them include

- All compressed air lines
- Assembly lines with pneumatic tools / Machinery with pneumatic systems
- Pneumatic control panels

Operation

To connect the coupling, simply push the plug in to the coupling.

To disconnect the coupling, push the sleeve back and the plug automatically comes out.

Safety precautionary note

During disconnecting under pressure, the plug comes out with high speed and force. Hence care to be taken to prevent injury.

Technical Specifications

Model No	Socket	WQC03...	WQC14...
	Plug	WQP03...	WQP14...
NW		5	8
Thread		1/4	1/2
Medium		Air	
Working Pressure range		0 - 10 bar	
Ambient temperature		-10° to +60° C	
Medium temperature		+5° to +50° C	
Flow (lpm)		1000	2250
Coupling load at 10 bar (kgf)		13	15
Materials of construction		Brass, Stainless steel, Nitrile & Acetal	

QUICK COUPLER

Series WQ

Cat No WQ - 01 - 01

MODEL WQC03 (NW - Ø5)

Socket

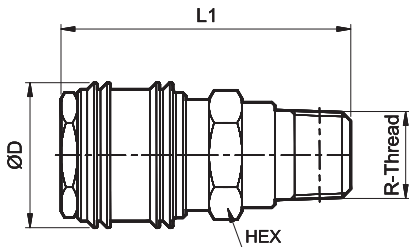

Thread	ØD	L1	HEX	Ordering No
R1/4	22	44	17	WQC03M51

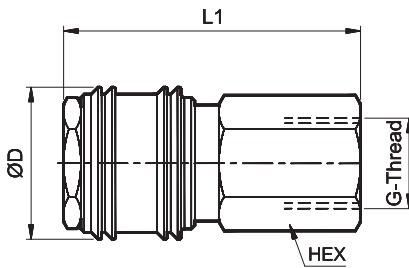

Thread	ØD	L1	HEX	Ordering No
G1/4	22	43	17	WQC03F61

MODEL WQP03

Plug

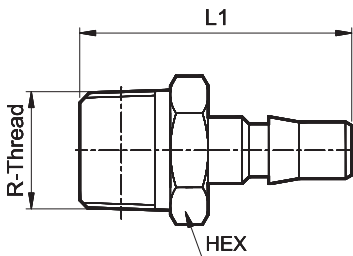

Thread	ØD	L1	HEX	Ordering No
R1/4	-	36.5	14	WQP03M51

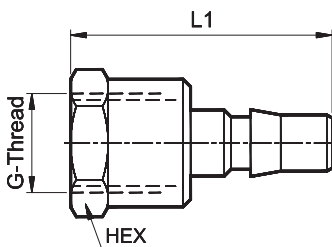

Thread	ØD	L1	HEX	Ordering No
G1/4	-	35	17	WQP03F61

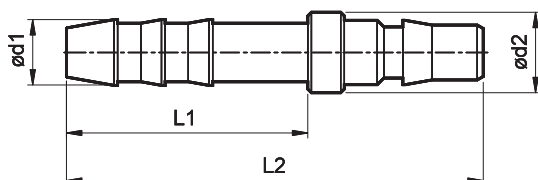

Applicable Hose ID	Ød1	Ød2	L1	L2	Ordering No
Ø8	9	11	33	57	WQP03T08

QUICK COUPLER

Series WQ

Cat No WQ - 01 - 01

MODEL WQC14 (NW - Ø8)

Socket

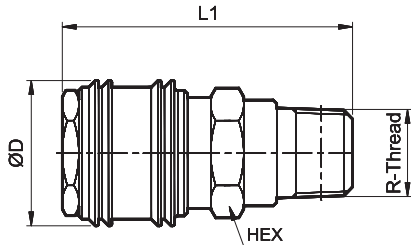

Thread	ØD	L1	HEX	Ordering No
R1/2	27.5	48.5	22	WQC14M53

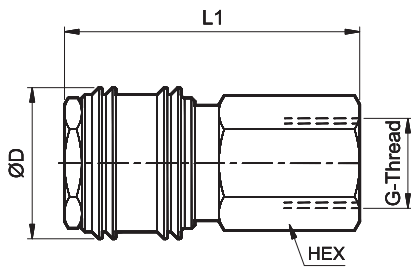

Thread	ØD	L1	HEX	Ordering No
G1/2	27.5	57	24	WQC14F63

MODEL WQP14

Plug

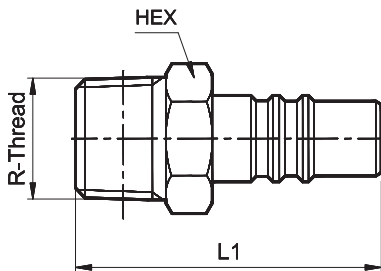

Thread	ØD	L1	HEX	Ordering No
R1/2	-	48	22	WQP14M53

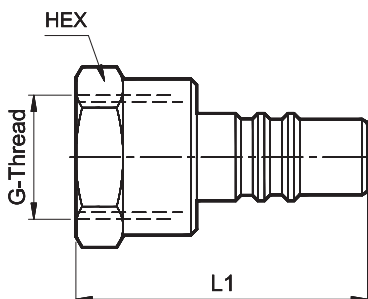

Thread	ØD	L1	HEX	Ordering No
G1/2	-	45	27	WQP14F63

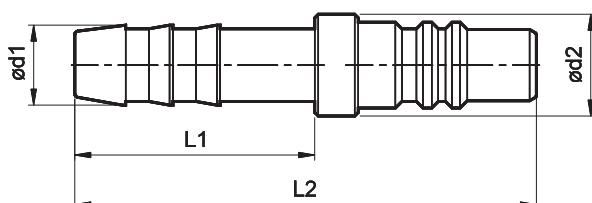

Applicable Hose ID	Ød1	Ød2	L1	L2	Ordering No
Ø10	11	14	33	63.5	WQP14T10

Subject to change